

W-630 Pouch Machine





The W-630 vertical-form-fill-seal pouch machine is a 4 axis servo controlled machine. The model W-630 forms a single lap seal pouch per cycle. Precision servo controls make the W-630 the accurate high output choice for bulk liquid applications.

- Servo driven, including ...
 - Horizontal seals, for repeatable seal pressure
 - Pull wheels, for precise pouch lengths
 - Squeegee rollers, for accurate consistent fill weights
 - Pump: For consistent fill
- Stainless steel USDA construction standard
 - 3A Dairy optional
- Positive closed loop film unwind system for superior film tracking
- Positive cut-off tube eliminates weight variations on stops and starts
- Thermal date coder or ink jet options
- Induction film splicing for quick, easy roll changes
- Independent temperature controls for seal
- Dispenser pack fitment capability
- On-line technical support through modem
- Recipe driven from user friendly HMI
- Dual control button stations for left or right hand operation

MODEL W630	
FILM WIDTH	Up to 24" (610mm)
PACKAGES PER CYCLE	One
PACKAGE WIDTHS	6" to 11" (150mm to 285mm)
PACKAGE LENGTHS	6" to 17" (150mm to 432mm)
CYCLES PER MINUTE	up to 50

PACKAGE STYLE	LAP SEAL POUCH. OPTIONAL FEATURES AVAILABLE INCLUDE EASY-OPEN AND FIT-MENTS
PRODUCTS PACKAGED	PUMPABLE LIQUIDS WITH OR WITHOUT PARTICULATES INCLUDING: SALAD DRESSINGS, SAUCES, CHEESE, CONDIMENTS, SALSA

LIQUID FILLED POUCHES	MINIMUM 34F (1C)
	MAXIMUM 195F (90C)
	PARTICULATE SIZE UP TO 1-1/8" (30mm)
	ZERO HEAD-SPACE POUCHES

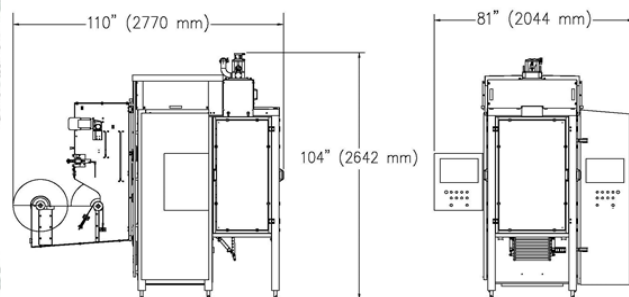
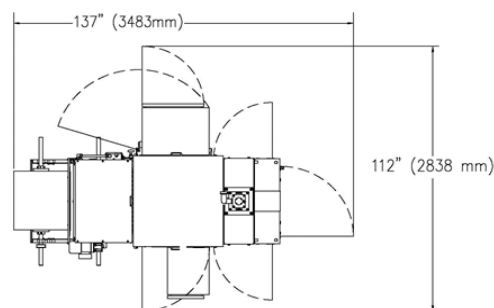

Winpak Lane, Inc.

998 S. Sierra Way
San Bernardino, CA
U.S.A. 92408

Tel: (909) 885-0715

Fax: (909) 381-1934

E-mail: info@wli.winpak.com

